

---

The following page(s) are extracted from multi-page Kuhnke product catalogues or CDRoms and any page number shown is relevant to the original document. The PDF sheets here may have been combined to provide technical information about the specific product(s) you have selected.

Hard copy product catalogues, and CDRoms have been published describing Kuhnke Pneumatics, Solenoids, Relays and Electronics; some divided into different books. A list of current publications is available on this web site or from our sales offices. Some may be available for download, but as substantially larger files.

## Contact Details

Kuhnke sales and service in the UK

H. Kuhnke Ltd  
Unit 6 Focus 303  
Focus Way, Walworth Business Park  
Andover  
Hampshire  
SP10 5NY  
United Kingdom

Tel: +44 (0)1264 364194  
Fax: +44 (0)1264 365991  
Email: [sales@kuhnke.co.uk](mailto:sales@kuhnke.co.uk)

### Important Note

The information shown in these documents is for guidance only. No liability is accepted for any errors or omissions. The designer or user is solely responsible for the safe and proper application of the parts, assemblies or equipment described.

---

### Foot Pedal, 3/2, 1/8 Ports

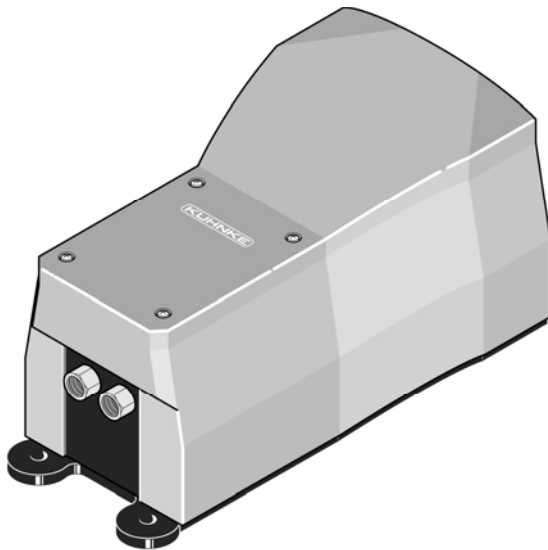

Foot pedal valves can be used to operate devices which hold work pieces in place on bench workstations or perform punching or drilling operations on production pieces. Housing shields pedal preventing accidental operation. Enclosure is constructed of polycarbonate and available in high visibility yellow or blue colours.

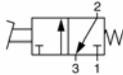
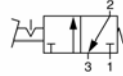
Description	Orifice Port	Color	Catalogue Number	
			Metric Ports Standard	NPT Ports** (USA Std.)
<b>3/2</b> Spring Return Normally Closed 	2mm 1/8	Yellow	<b>76026-68-21</b>	75026-68-21
	2mm 1/8	Blue	<b>76026-69-21</b>	75026-69-21
<b>3/2</b> Latch/Unlatch Normally Closed 	2mm 1/8	Yellow	<b>76026-68-29</b>	75026-68-29
	2mm 1/8	Blue	<b>76026-69-29</b>	75026-69-29

\*\* For NPT versions, a metric ported foot pedal unit is supplied with NPT fitting adaptor kits.

Operating pressure range is 0 to 10 bar. Actuation force @ 6 Bar, is approx. 35 N.

Enclosure dimensions are 228mm L x 141mm W x 117mm H. Enclosure- polycarbonate, valve body- aluminum housing with Buna N seals.

Foot pedals with 2mm orifice valves have an internal non-accessible exhaust port.

### Foot Pedal, 1/4 Ports

Foot pedals are available in 3/2 or 5/3 spring return or maintained versions. Latching pedals can be used to lock work pieces in place, while spring return units can be used to perform work operations like punching, pressing etc.

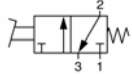
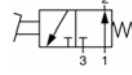
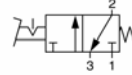
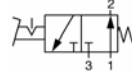
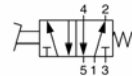
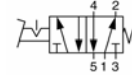
Description	Orifice Port	Colour	Catalog Number	
			Metric Ports Standard	NPT Ports** (USA Std.)
<b>3/2</b> Spring Return Normally Closed 	8mm 1/4	Yellow	<b>76046-68-21</b>	75046-68-21
	8mm 1/4	Blue	<b>76046-69-21</b>	75046-69-21
<b>3/2</b> Spring Return Normally Open 	--	--	--	--
	8mm 1/4	Blue	<b>76046-69-31</b>	75046-69-31
<b>3/2</b> Latch/Unlatch Normally Closed 	8mm 1/4	Yellow	<b>76046-68-29</b>	75046-68-29
	8mm 1/4	Blue	<b>76046-69-29</b>	75046-69-29
<b>3/2</b> Latch/Unlatch Normally Open 	--	--	--	--
	8mm 1/4	Blue	<b>76046-69-30</b>	75046-69-30
<b>5/2</b> Spring Return 	8mm 1/4	Yellow	<b>76047-68-41</b>	75047-68-41
	8mm 1/4	Blue	<b>76047-69-41</b>	75047-69-41
<b>5/2</b> Latch/Unlatch 	8mm 1/4	Yellow	<b>76047-68-49</b>	75047-68-49
	8mm 1/4	Blue	<b>76047-69-49</b>	75047-69-49

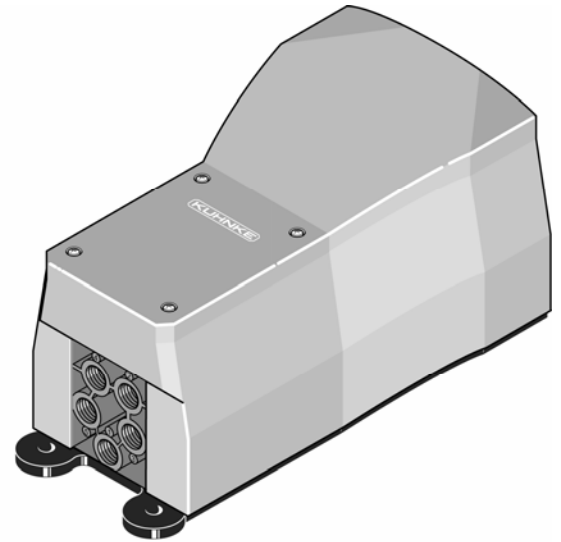

\*\* For NPT versions, a metric ported foot pedal unit is supplied with NPT fitting adaptor kits.

Operating pressure range is 0 to 10 bar. Actuation force @ 6 bar, is approx. 35 N.

Enclosure dimensions are 228mm L x 141mm W x 117mm H. Enclosure- polycarbonate, valve body- aluminum housing with Buna N seals.